

South Carolina

Pursuant to a Precept issued under the hand and seal of John Bremer Esq. Deputy Surveyor Genl. bearing date the 5th day of February 1782 I have admeasured and laid out unto Jeremiah Ruff a plantation or tract of land in Swain County containing Two hundred acres, situate lying and being all branches of Mitchels Creek bounding land on West, Thomsons land and East by John Woods land, and N.E. by North land N.W. by Daniel Plummers land, and S.W. and S. by every Breeds land S.W. and N.W. by Hare Jackson, and hath such shape form and Marks as the above Plat Represents
 Certified under my hand the 11th of May 1784 Will: Gist Esq.
 Recorded the 16th August 1784

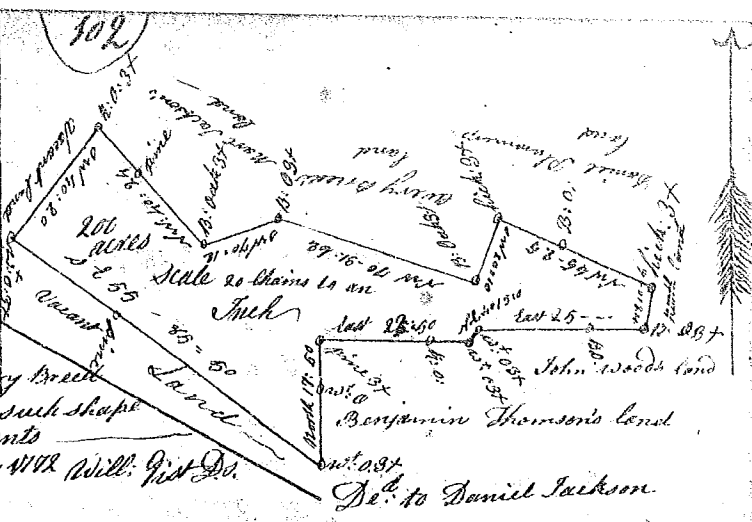

State of South Carolina Ninety six District, East side of the ancient Boundary line

Pursuant to a warrant from John Thomas Esq. Commissioner of Location bearing date the 11th day of June 1784 I have admeasured and laid out unto Ralph Smith Esq. a tract of land containing Three hundred and forty acres lying on a small Branch of James Creek bounded to the S.W. by Nathaniel Williams Youngs land to the N.W. by that Youngs land, and hath shape and Marks as the above Plat Represents
 Surveyed the 16th day of June 1784
 Recorded the 16 August 1784 Phil. Waters Esq.
 De: to Ralph Smith Esq.

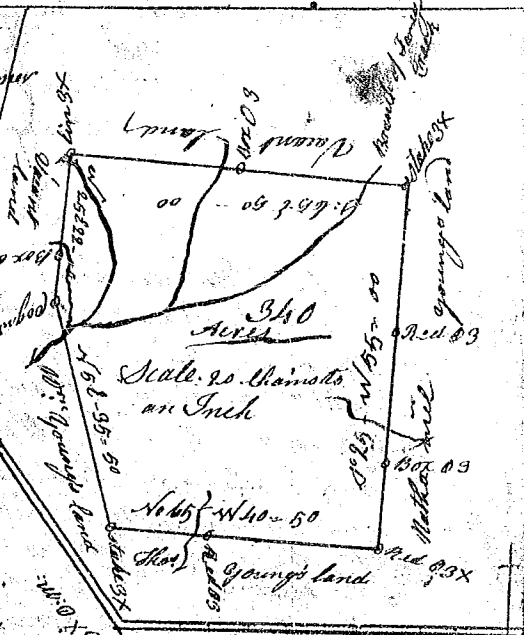

South Carolina

Pursuant to a Precept from Francis Bremer Esq. Deputy Surveyor Genl. Dated the 5th day of May 1775 I have admeasured and laid out unto John Rodgers a tract of One hundred and fifty acres of Land situate in Ninety Six District on a branch called Beaverdam the Waters of Little River. Bounded S. and W. on land of Joseph Babby N. and E. on lands of William Drew and hath such shape form and marks as the above Plat Represents Surveyed the 2nd day of July 1775
 Recorded the 20th of August 1784 John Rodgers Esq.
 De: to Rodgers for S. Rodgers



State of South Carolina Ninety six District

On the east side of the ancient Boundary Pursuant to a warrant from under the hand & seal of John Thomas Esq. Commissioner of Location bearing date the first day of June 1784 I have admeasured and laid out unto William Simpson of Tract of Land lying on Both sides of the north fork of Mill Creek containing two hundred and fifty acres Bounded to the S. by Joseph Heabitts land & N. by the said William Simons land to the N.W. by David Bannings and Eastwardly by Vacant Land and hath such shape and marks as the above plat Represents
 Survey the 1st July 1784 Certified by 11 States Esq.
 Recorded the 2d Augt 1784

